

WALGREENS - DORT & DAVISON

2815 Davison Road / Flint, MI



MID-AMERICA[®]
Real Estate-Michigan, Inc.



RETAIL OPPORTUNITY

WALGREENS - DORT & DAVISON



Address

2815 Davison Road
Flint, MI 48506

Availability

15,120 SF

Features

The property is located on the northeast corner of Dort Highway and Davison Road in Flint, MI. Built in 2000, this 15,120 square foot building, with a drive-thru, is positioned on the hard corner offering maximum visibility with three access points to the site. There is electronic pylon signage at the traffic controlled intersection. Walgreens successfully operated in this location for over 20 years.

Area Tenants



Demographics

	1 MILE	3 MILES	5 MILES
POPULATION	10,768	55,826	145,979
HOUSEHOLDS	4,243	22,572	58,095
AVG HOUSEHOLD INCOME	\$40,517	\$41,445	\$44,872
DAYTIME POPULATION	10,593	68,976	150,551

WALGREENS - DORT & DAVISON

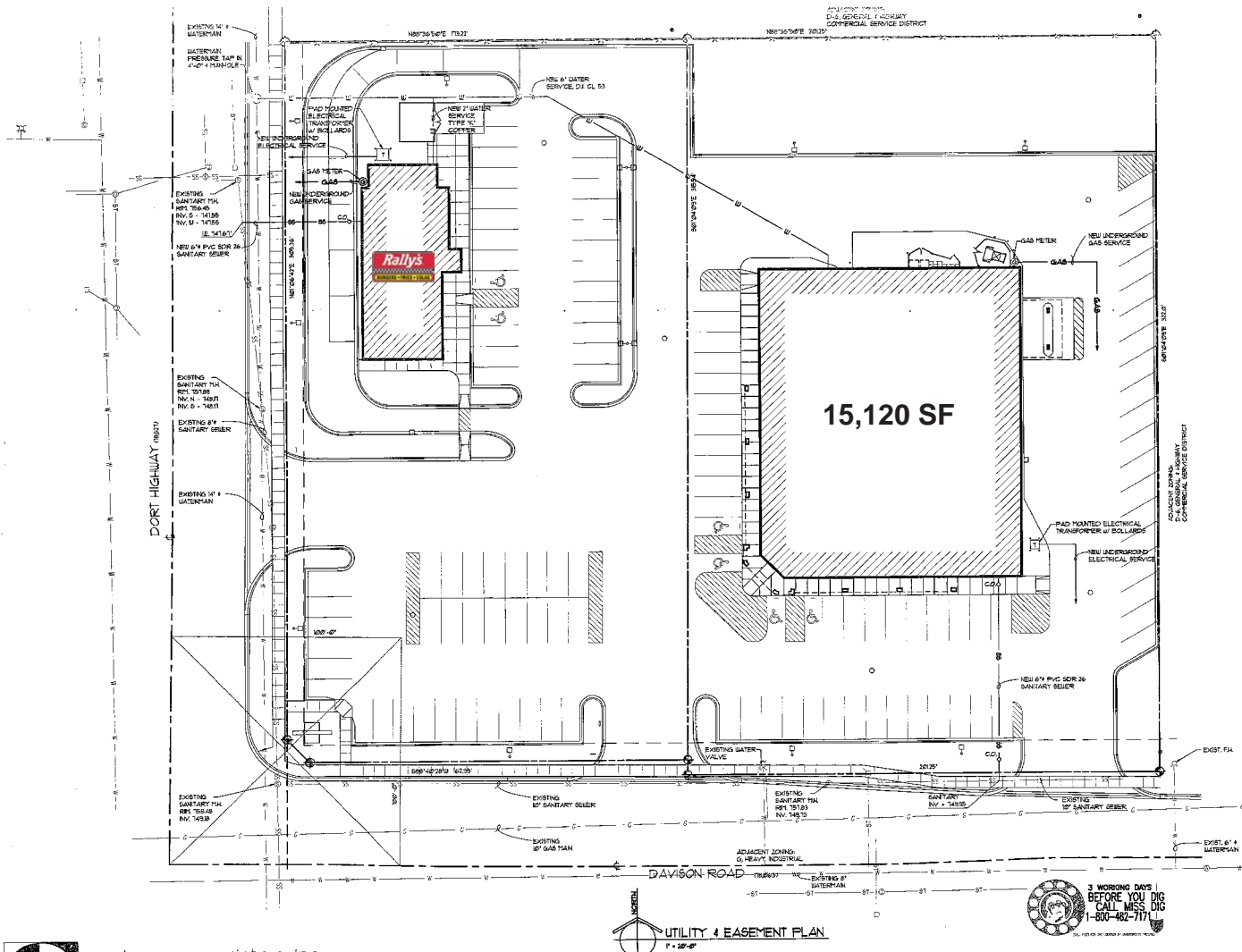

grainger associates, inc.

307 east third street • flint, michigan 48502
(810) 767-7510 • fax (810) 767-4844

project title: NEW WALGREENS PHARMACY (STORE #9817) drawing title: UTILITY & EASEMENT PLAN
(NEC) DORT HWY. AND DAVISON ROAD
FLINT, MI 48506

ISSUED FOR S.P. REVISED 11-13-19
ISSUED FOR OWNER'S REVIEW 2-22-2020

SITE PLAN

WALGREENS - DORT & DAVISON



WALGREENS - DORT & DAVISON

Eric
Unatin

Mid-America Real Estate -
Michigan, Inc
T: 248.385.5023
EUnatin@MidAmericaGrp.com

Brad
Rosenberg

Mid-America Real Estate -
Michigan, Inc
T: 248.385.5001
BRosenberg@MidAmericaGrp.com



38500 Woodward Avenue
Suite 100
Bloomfield Hills, MI 48304
248.855.6800
MidAmericaGrp.com



CONTACT